

WIENERSTRASSE 9, A-7082 DONNERSKIRCHEN
ÜBERSICHTSPLAN
HAUS 0.7
1.OBERGESCHOSS

LAYOUT
HOUSE 0.7
SECOND FLOOR

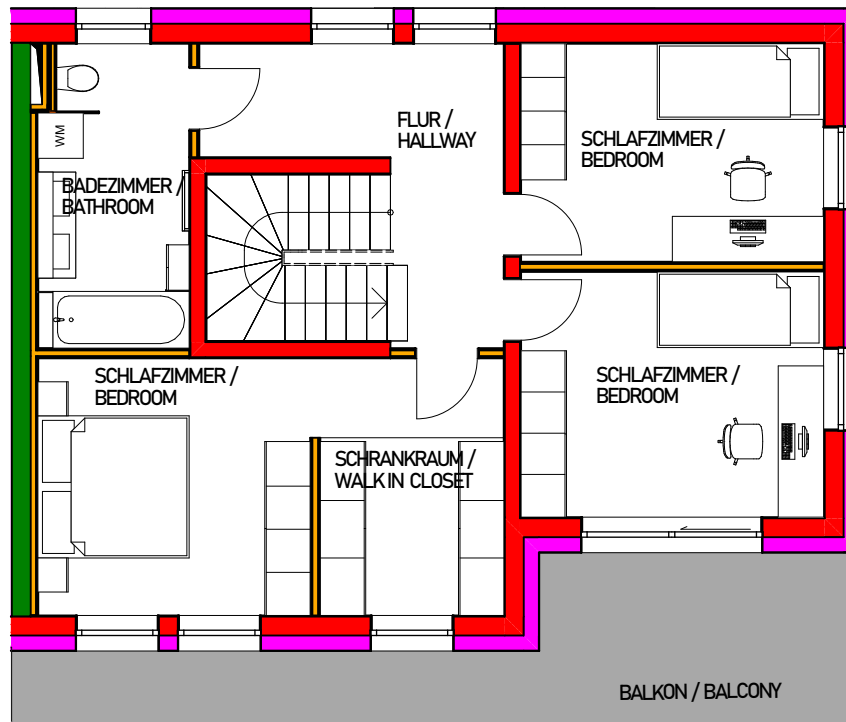

HOUSE 0.7
ca. 62 m²
BALCONY
ca. 16 m²
PARKING LOT 1
ca. 14 m²
PARKING LOT 2
ca. 14 m²

HAUS 0.7
ca. 62 m²
BALKON
ca. 16 m²
PARKPLATZ 1
ca. 14 m²
PARKPLATZ 2
ca. 14 m²

Terra Atlas

IMMOBILIEN GMBH